

PAINTING AND APPLYING DECALS

Methods of painting and applying decals are specified both on this page and in assembly instructions and figures. Some part of these work should be done in the course of assembly work. There are two kinds of decals in the kit—SLIDE MARK and STICKER.

Use paints only for plastics. SLIDE MARK should be applied after the paint has dried completely. Small parts should be painted while still on the sprue.

[\(Top\)](#)

There had been almost no change in body colour between June 1967 when the machine made its debut and May 1968 when it was sponsored by the Goldleaf Corporation.

Yellow stripe runs from nose cowling to below the roll bar against British green body colour. When you do not use SLIDE MARKS of yellow stripe but want to paint yourself, apply that of the emblem of Lotus and letters "LOTUS" alone upon the painted stripe on the nose.

The area where the pipe overlaps number circle should be painted in white to the same width.

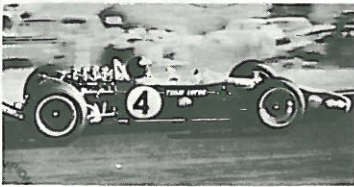

[\(Below\)](#)

With the sponsorship of the Goldleaf Corporation, a tobacco company, since May 1968, its body colour became more showy than ever. The main body is painted in three distinctive colours of red, gold, and white as in the diagram. The body side line should be located slightly below the position of the pipe. However, the center of the line had better be in the same place. The detail paintings of the engine: follow the colour indications in the figures.

Rim of Steering Wheel: Wood
Mufflers: forward from the connection Flat white backward Chrome plating (parts colour)

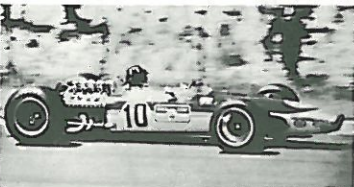

[\(Painting the Tyres\)](#)

Some places of the tyres (arrowed in the diagram) are coloured as shown. With this accent, your model will surely look much better.

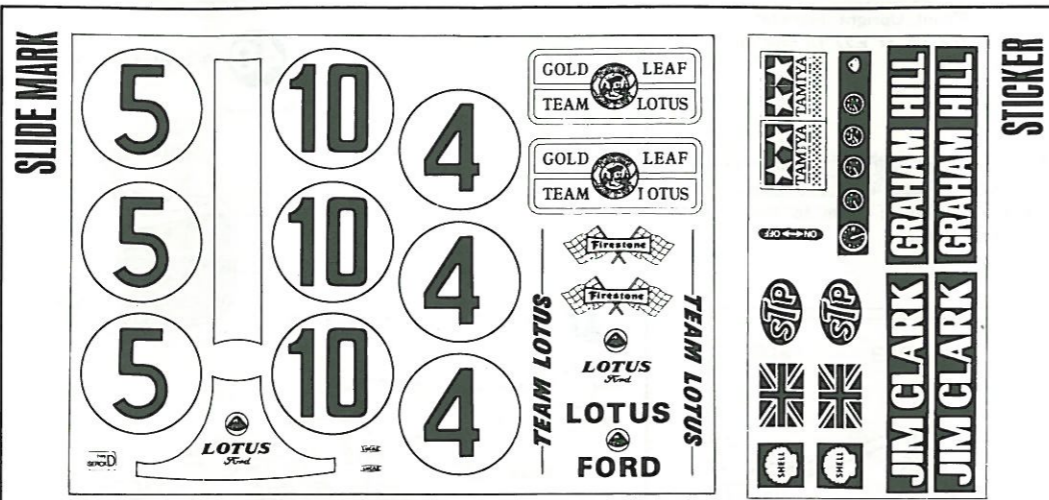
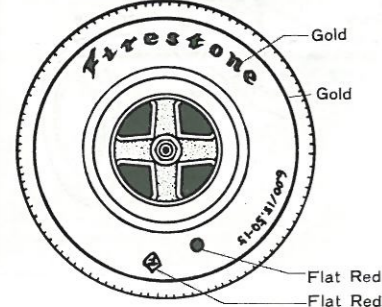

The box top shows the painting of 1967 Dutch GP machine.

The painting of 1968 South African GP machine.

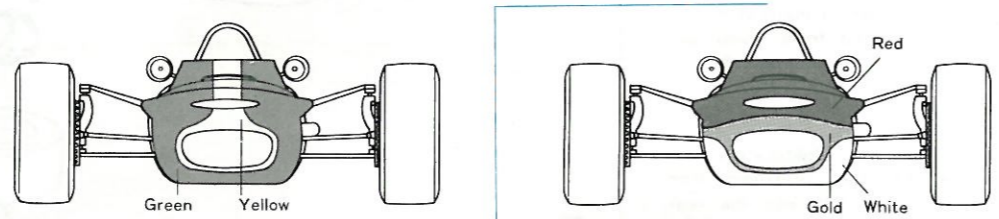
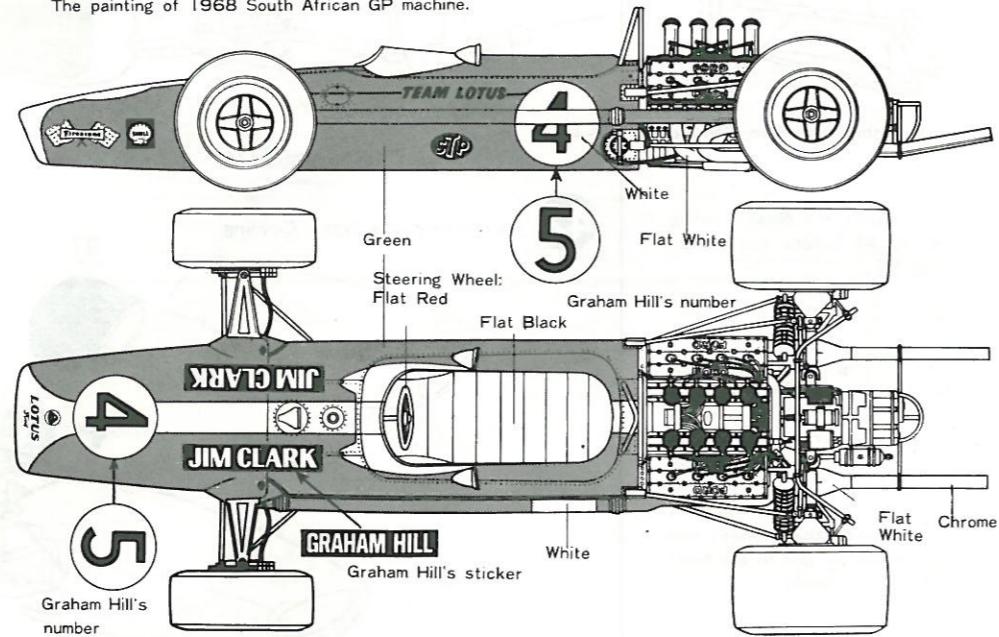

Painting of 1968 Spanish GP.

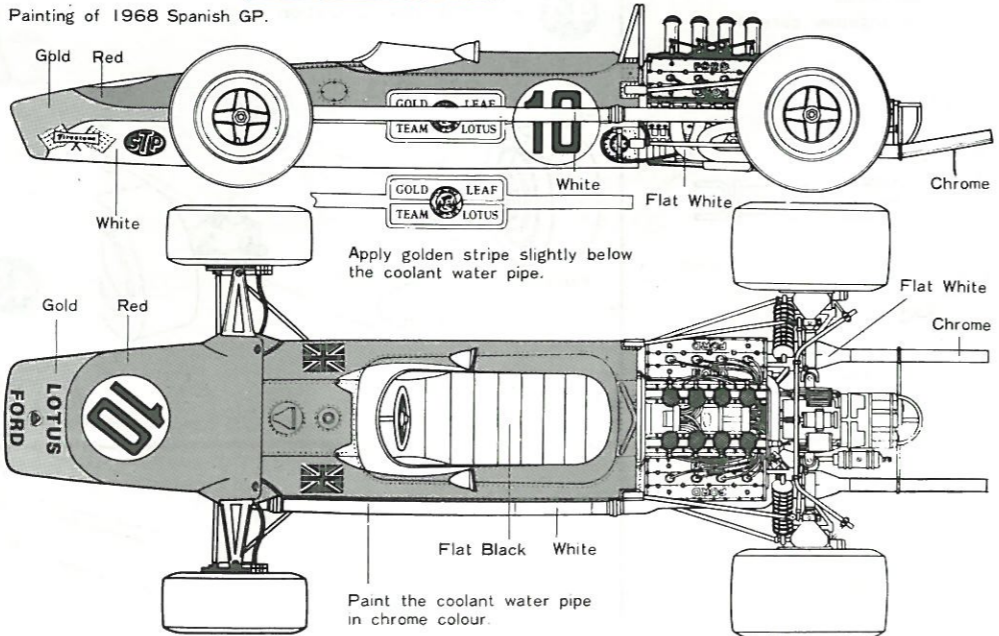

PARTS

A PARTS

1. Right Body
2. Left Body
3. Upper Chassis Panel
4. Cowling
5. Windshield

C PARTS

1. Cap A
2. Cap B
3. Crank Case (right)
4. Upper Crank Case
5. Crank Case (left)
6. Transmission (right)
7. Upper Oil Tank
8. Lower Oil Tank
9. Transmission (left)
10. Lower Journal Stopper
11. Upper Journal Stopper
13. Cap for Front Wheel
14. Water Pump (right)
15. Water Pump (left)
16. Oil Pipe
17. Oil Scavenge Pump (right)
18. Oil Scavenge Pump (left)
19. Starter Motor
20. Ignition Coil
21. Throttle Plate (right)
22. Throttle Plate (left)
23. Crank Case (rear) A
24. Oilpan
25. Fuel Injection Pump (A)
26. Fuel Injection Pump (B)
27. Crank Case (front)
28. Disk Brake Caliper (front)
29. Disk Brake Caliper (rear)
30. Distributor B
31. Fuel Filter
32. Mission Case (rear)
33. Upper Mission Case
34. Master Cylinder for Clutch
35. Master Cylinder for Brake
36. Battery Holder
37. Crank Case (rear) B

F PARTS

1. Exhaust Pipe A (right)
2. Exhaust Pipe B (right)
3. Exhaust Pipe C
4. Exhaust Pipe D
5. Exhaust Pipe B (left)
6. Exhaust Pipe A (left)
7. Rear Wheel A
8. Rear Wheel B
9. Front Wheel A
10. Front Wheel B

M PARTS

1. Battery Mount (A)
2. Switch Metal
4. Battery Mount (B)
5. Pinion Gear Mounted Shaft
6. Cowling Fixing Metal
7. Screw
8. Coil Spring (small)
9. Coil Spring (large)
10. Gear Box

A PARTS

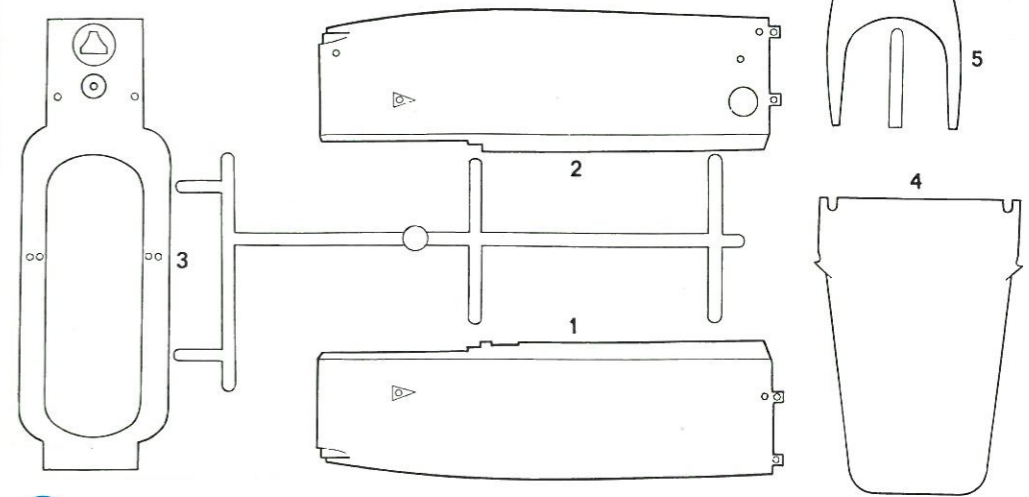

C PARTS

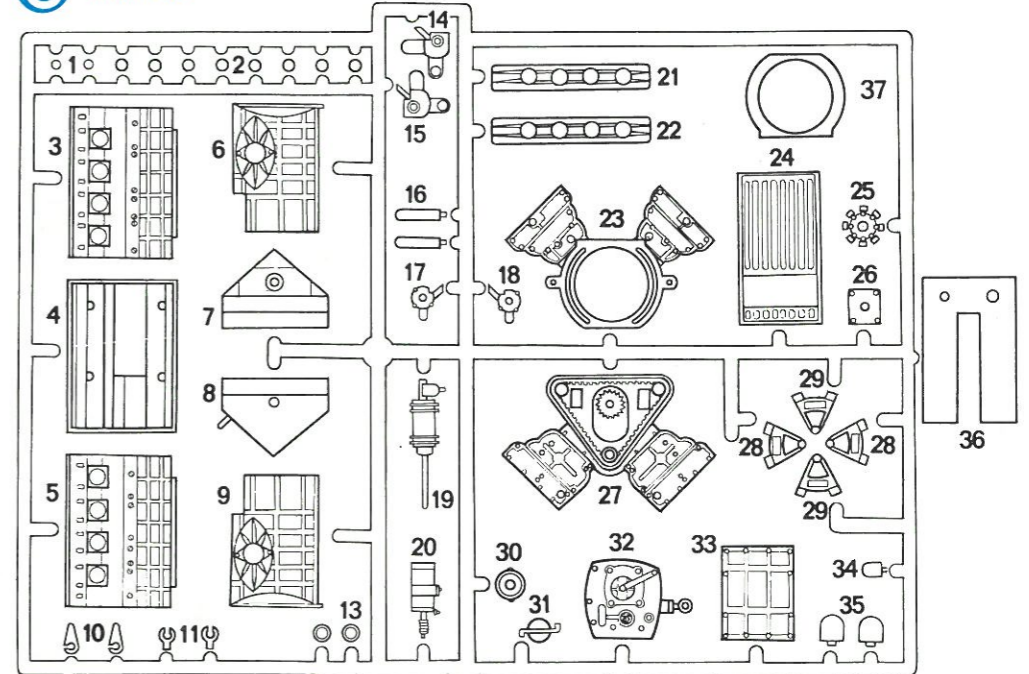

F PARTS

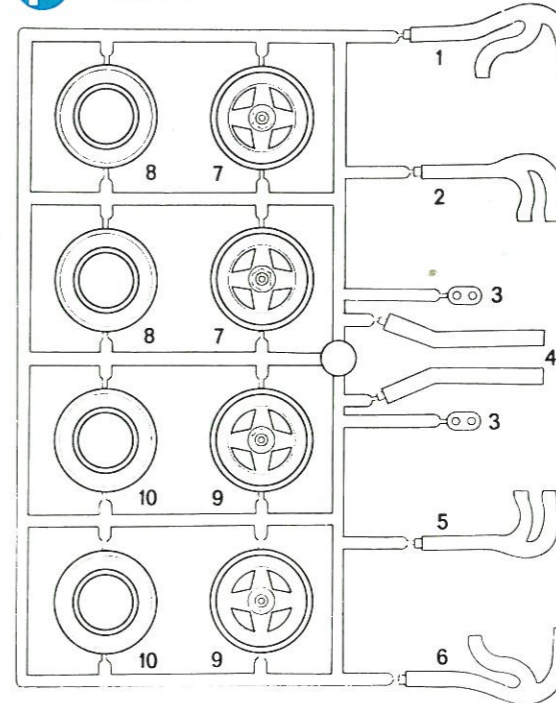

M METAL PARTS

